

Mounting instructions for SMA Plugs: 245-CON-SMA-V3 / 245-CON-SMA-CER-V3

Supplied parts:

Nr	245-CON-SMA-V3	245-CON-SMA-CER-V3
1	Front part / Insulator 1 (1+2 already assembled)	Front part
2		Insulator 1, ceramic
3	Pin	
4	Insulator 2	Insulator 2, ceramic
5	Back part	
6	Crimp Ferrule	

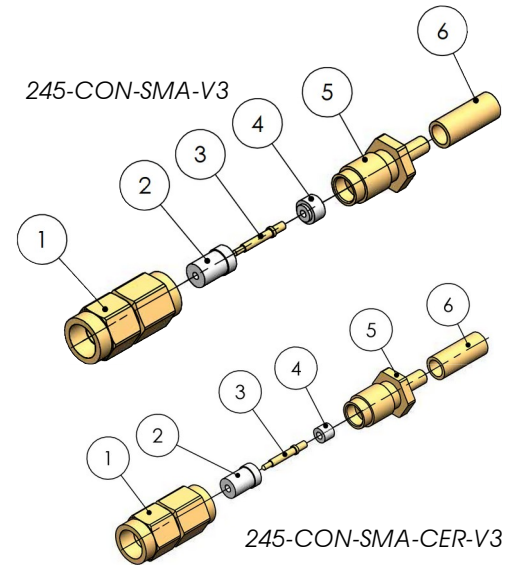

- 1) Stripping the cable (311-KAP50 / 301-KAP50 or similar):
A=4mm / B=10mm / C=19mm

Tin-coat the inner conductor

- 2) Put the crimp ferrule (6) over the cable
Open the shielding wires and push the Back part (5) onto the cable

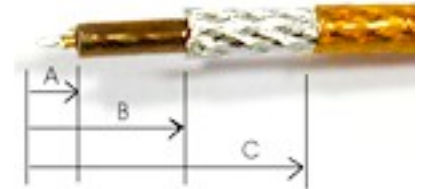

- 3) Put insulator 2 (4) over the inner conductor. Please note the direction.
ceramic version is symmetric

Solder the inner connector to the pin (3)
Check for proper connection
Wash off carefully any remaining flux with alcohol (Ethanol or Isopropanol)



- 4) Only Ceramic version: Place the ceramic insulator (2) into front part (1)

- 5) Put the assembled part into Front part (1+2) and screw the parts together

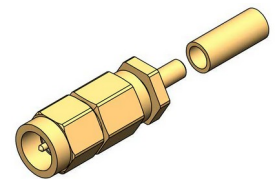

- 6) Push the Crimp tube (6) over the shielding of the cable and part (5), crimp with diameter 3.25mm

Recommended tools:

- 1) Wire stripper 321-STRIP10
- 2) UHV Solder and flux 315-LF-SOLDER
- 3) Crimp tool 321-CTOOL-SMA
- 4) Spanners SW8
- 5) Solder iron